

## Battery Positive Cable Replacement

### Removal Procedure

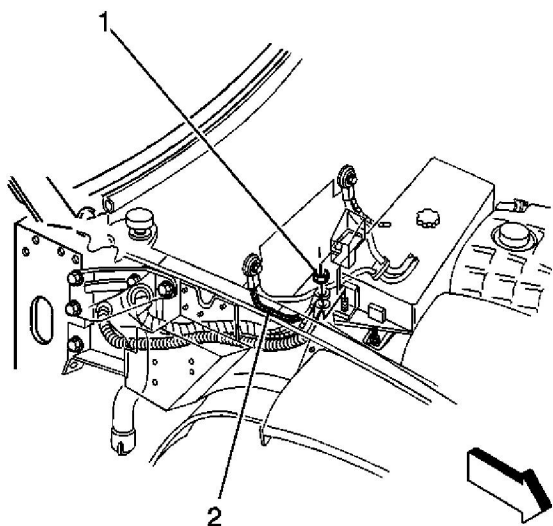

1. Remove the battery tray. Refer to [Battery Tray Replacement](#).
2. Open the stud cover on the fuse/relay center.
3. Remove the positive battery cable nut from the fuse/relay center stud.
4. Remove the positive battery cable lead (2) from the fuse/relay center stud.

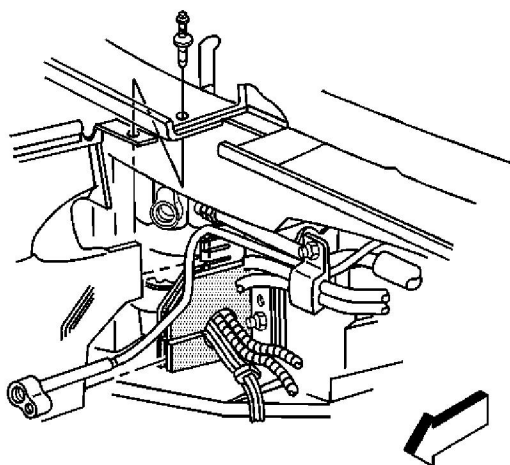

5. Remove the heat shield retainer at the upper plenum.

© 2014 General Motors Corporation. All rights reserved.

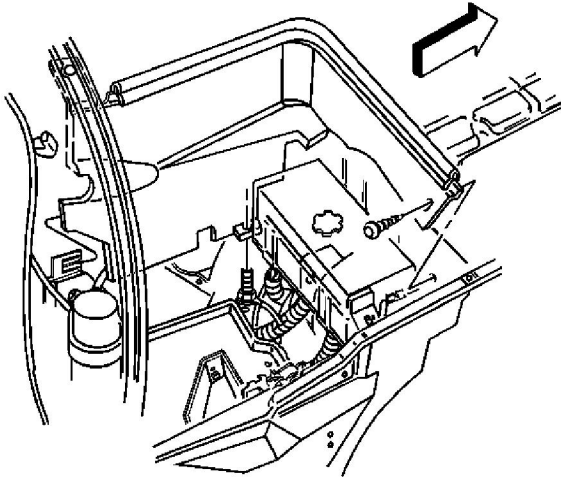

6. Remove the battery heat shield retainer and the battery heat shield.
7. Remove the right rear spark plug wire.

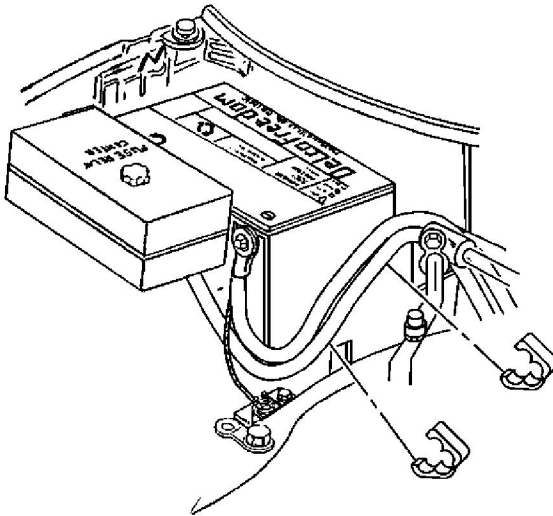

8. Remove the battery cable clips.

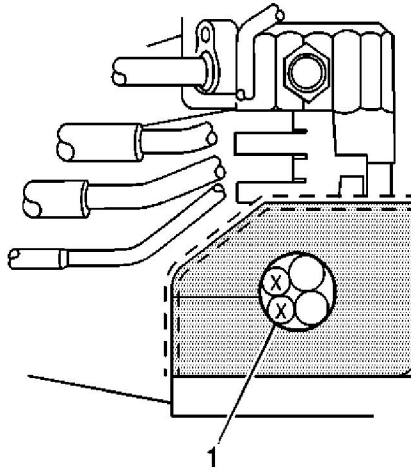

9. Remove the battery cables (1) from the engine wiring harness insulator.
10. Raise and suitably support the vehicle. Refer to [Lifting and Jacking the Vehicle](#) in General Information.

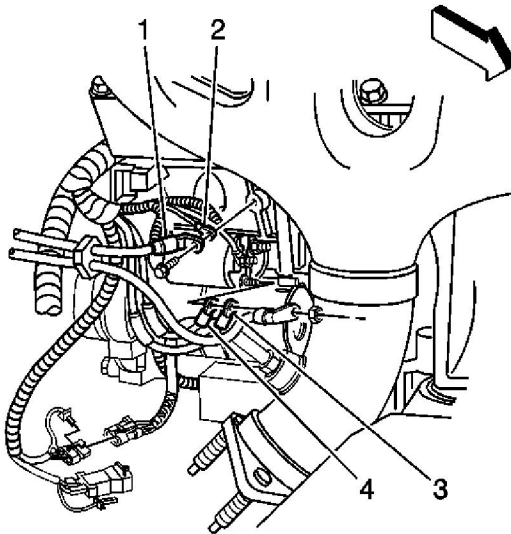

11. Remove the positive battery cable terminal nut and terminals (3, 4) from the starter solenoid.
12. Lower the vehicle.
13. Remove the positive battery cable.

## Installation Procedure

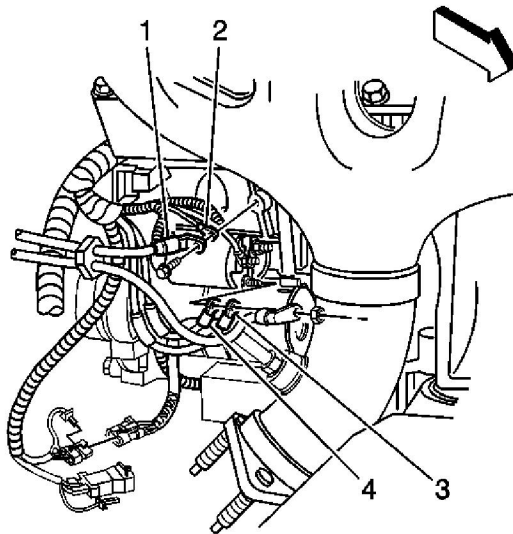

1. Install the positive battery cable.
2. Raise the vehicle.

**Notice:** Use the correct fastener in the correct location. Replacement fasteners must be the correct part number for that application. Fasteners requiring replacement or fasteners requiring the use of thread locking compound or sealant are identified in the service procedure. Do not use paints, lubricants, or corrosion inhibitors on fasteners or fastener joint surfaces unless specified. These coatings affect fastener torque and joint clamping force and may damage the fastener. Use the correct tightening sequence and specifications when installing fasteners in order to avoid damage to parts and systems.

**Important:** Ensure that the engine harness leads (3, 4) are positioned on the solenoid prior to the positive cable terminal being installed.

3. Install the positive battery cable terminals (3, 4) and nut to the starter solenoid.

#### **Tighten**

Tighten the positive battery cable nut to 8 N·m (71 lb in).

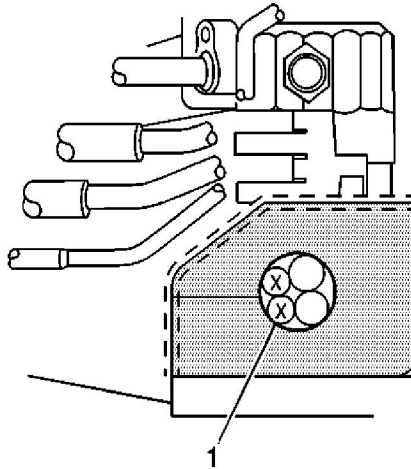

4. Install the battery cables (1) to the engine wiring harness insulator.

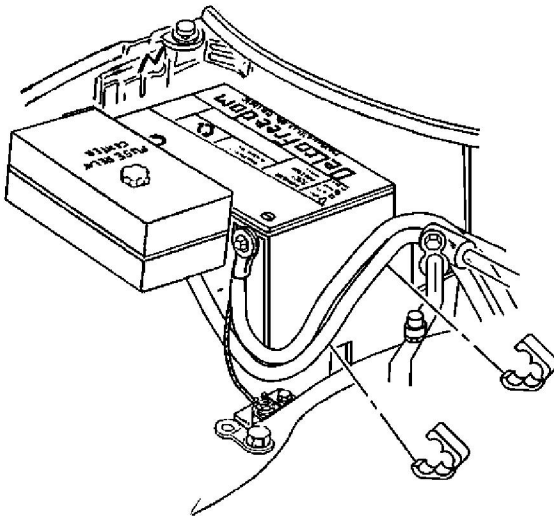

5. Install the battery cable clips.
6. Install the right rear spark plug wire.

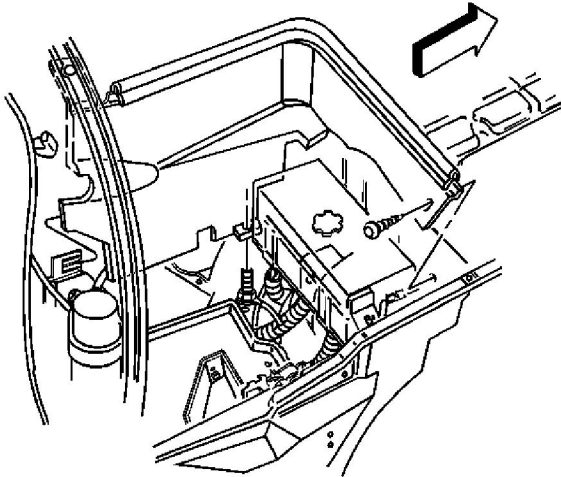

**Important:** Ensure that two fingers of the heat shield bracket are on either side of the heat shield, and the shield is inserted into the notch in the insulator.

7. Install the battery heat shield.
8. Install the heat shield retainer at the wheelhouse panel.

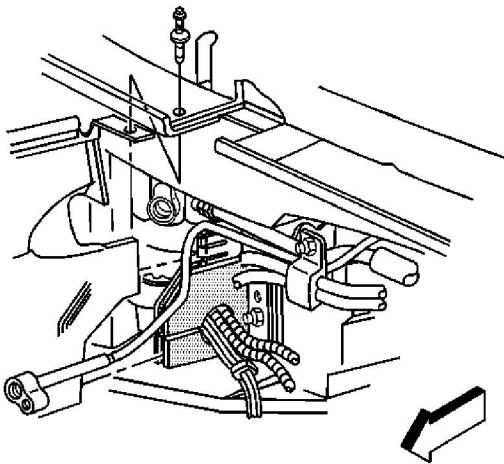

9. Install the heat shield retainer at the upper plenum.

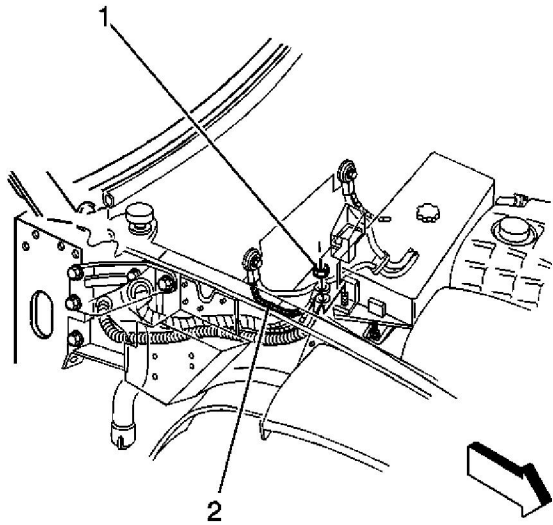

10. Install the positive battery cable lead (2) to the fuse/relay center stud.
11. Install the positive battery cable nut to the fuse/relay center stud.

**Tighten**

Tighten the positive battery cable nut to 10 N·m (89 lb in).

12. Close the stud cover on the fuse/relay center.
13. Install the battery tray. Refer to [Battery Tray Replacement](#) .